



First Class

August 2019

Issue No. 62

Honesty

Respect

Happiness

Achievement

Welcome Back

We hope you've all had a wonderful summer holiday and that you've made the most of the sunny weather. We are all looking forward to the 2019-20 session.



Fintray Road Crossings

Two zebra crossings are situated on Fintray Road. We would like to encourage children to use the crossing at the bottom of the hill. The playground gate is the Pupil Entrance to the School. This crossing will also be supervised by Florence, our crossing patroller.

Morning Drop-Off

Pupils should arrive at school from 0850 and enter the school site via the playground entrance gates. These gates will be closed at

9am. For safety reasons, please do not gather around the gates or on the pavement. Parents are welcome to come into the playground until their children have established a routine. There is no supervision in the playground before 9am. The Primary 6 Buddies will be on hand to help any of the younger children.

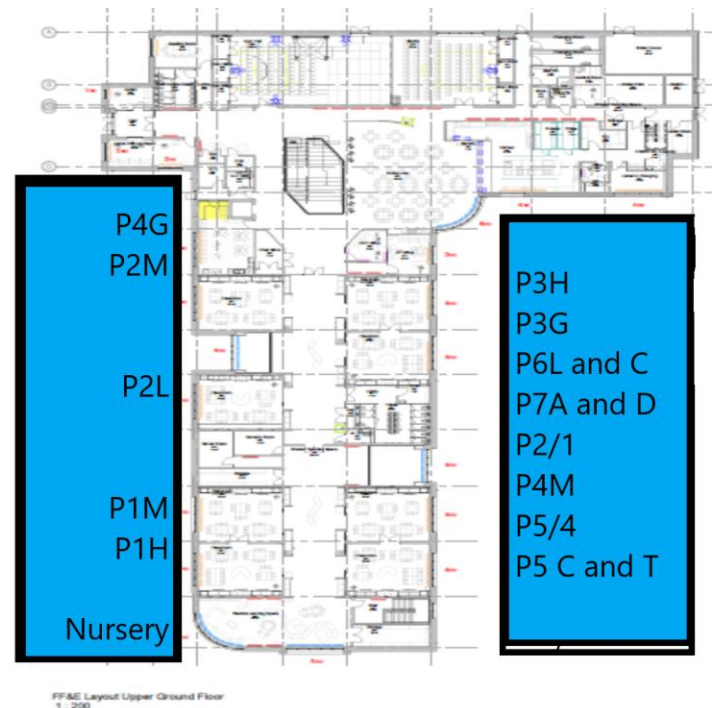

We would encourage children to walk or 'scoot' to school. We have facilities to 'park' scooters at the main entrance and inside the playground gates.

For safety reasons and due to the steep decline/incline, we would like to request that all

children disembark scooters and bikes from the school entrance to the entrance at the bottom of the road.

If you have to drive your children to school, please use the car park at the MUGA and walk over to school. There is a new sign at the drop off zone for taxis and other school transport. The transport companies need to access this to drop off children. The car park at the main school entrance is strictly for Staff, Disabled Access and Visitors only. This should **never** be used to drop children off as this may cause issues and congestion with the new crossings. We thank you for your co-operation in this matter.

Pick up - 1515

Primary 1 and 2 children should be collected by a responsible person (this may include siblings). It is essential that Class Teachers are aware of arrangements and if someone different is going to collect your child, please ensure you inform the Class Teacher by letter or email.

During Primary 3 some parents may feel that it is appropriate for their child to walk home independently. We would encourage this independence but again ask that you keep the Class Teacher informed. Primary 3 pupils on the far side of the school will meet at the tree with the bench surrounding it for collection.

Pupils will be exiting the same door they entered in the morning. At the pick up point, teachers will line the children up. When your child reaches the front of the line please come forward to collect them. For safety reasons it is essential that teachers 'hand over' your child to you rather than sending them to locate you in

the playground. Once you have collected your child please leave the pick up area to keep the area as clear as possible.

P4-7 will be dismissed from their classrooms. The expectation is that they will walk independently. If this is not the case or if there is a change to the arrangements, please let the Class Teacher know.

Please respect classes and teachers at the beginning and end of the day by staying clear of doors and windows.

The Club@Kinellar

We are delighted that The Club@Kinellar is growing from strength to strength.

If you would like to enquire about spaces, please email or call them directly.

theclubmidmill@gmail.com

07740 547020

The turning circle beyond the gates in the top car park of the school must not be used for parking as delivery lorries cannot turn.

Lunches

P4-7 – 1220-1315

P1-3 1240-1335

If your child is a home lunch they should be met at the front door. If your child is in P4-7 and you are happy for them to walk home independently please let the class teacher know. They should return to school via the Playground gates.

iPay Impact

This is the system used to pay for lunches. Admin will issue our new pupils (P2-P7 only) with log-ins by the end of August. P1s will follow by end of September.

Open Evening

We plan to hold our usual 'Meet the Teacher' event this year. Thursday the 19th of September will be open to parents and children to visit their classroom and meet their teacher/s.

School Uniform

Children are expected to wear school uniform- this includes black shoes. We hope that creating a strong identity for the children will help them to take pride in their school community.

Now that we are a 400+ pupil school, we are experiencing a huge volume of lost property. All uniform items, jackets and lunch boxes should be named. Un-named items will be held for a short period of time before being disposed of.



PE Kits

Pupils should ensure they bring the correct PE kits to school each week. Pupils will require an indoor kit containing a t-shirt, shorts, socks and

indoor shoes. They will also require an outdoor kit for the MUGA/field. This should contain a t-shirt, jumper, trousers, socks and outdoor shoes. Trousers are advised as the MUGA has a hard surface. Class Teachers will inform you of when children will need an outdoor kit. We encourage pupils to wear their House T-shirts for PE.

Kit List

It would be helpful if your child has the following items for school:

- Stationery – pencils, sharpener, rubber, ruler, (glue sticks are helpful) **NO SCISSORS OR COMPASSES**
- PE kit – see above
- Water Bottle
- Waterproof Jacket

Teachers may request other items such as folders at a later date.

Calendar

A full calendar will be available on the school website in the near future. Please check this regularly as this will be updated throughout the year.

School Office

Please find our contact details below.

Kinellar School
Fintray Road
Blackburn
Aberdeenshire
AB21 0SR

01224 472888

kinellar.sch@aberdeenshire.gov.uk

Understandably the School Office will be very busy for the first few weeks. If possible, please communicate directly with Class Teachers. Email addresses will be issued shortly.

Please ensure your child arrives at school with all of their belongings. It can prove difficult for the office staff deliver items to classrooms. Please ensure children arrive at school on time. If your child is late this will impact on teaching and learning and will be recorded. This is also time consuming for the Admin Team.

Contact us

As always if there is anything we can help you with, please do not hesitate to contact us

Mrs Pamela Farquhar - HT

pamela.farquhar@aberdeenshire.gov.uk

Mrs Ruth Stannard – DHT

Ruth.stannard@aberdeenshire.gov.uk

Miss Cara Morrison- Acting DHT

cara.morrison@aberdeenshire.gov.uk

Amelia Davies - Acting DHT

amelia.davies@aberdeenshire.gov.uk