



First Class

August 2018

Issue No. 52

Honesty

Respect

Happiness

Achievement

Welcome Back

We hope you've all had a wonderful summer holiday and that you've made the most of the sunny weather.



It has been a busy summer at Kinellar but we are really looking forward to welcoming everyone to our new building. The move went to plan and the boxes have all been emptied and uplifted.



As you will have noticed the Nursery was very quickly demolished to make way for our MUGA (Multi-Use Games Area) and outdoor store/toilets.

The Big Move

Thank you to those who helped us at Midmill in the run up to the move. We were very pleased that, with your help, we were able to leave Midmill as we had found it. This was extremely important to us as the Staff and Pupils at Midmill had been so welcoming and accomodating during our stay!

Thank you also to Mrs Fortune and Mrs Barnard who have taken care of moving and organising of our library.

Thank You

We would like to show our appreciation to Morrison Construction. They have worked extremely hard to create this fantastic facility for us. They have also been here this summer to meet our many demands.



Staffing

Fintray Road Crossings

The classes for this session are as follows:

P1H Mrs Carol Hendry / Ms Lisa Shepherd
P1P Miss Ashley Pollard
P2/1 Miss Cara Morrison/ Miss Kerry Hay
P2M Mrs Agnes Morrison
P3G Mrs Jackie Gibb
P3M Mrs Emma Martin
P3/4 Mrs Claire Moore/ Mrs Joanna Garden
P4D Mrs Amy Duckers
P4/5 Mrs Karen Clark
P5T Miss Jen Tocher
P6/5 Miss Chay Crawford/ Mrs Jen Lovie
P6H Miss Abbie Hammond
P7/6 Miss Rachel Singer
P7A Miss Francesca Adair
P7D Mrs Amelia Davies

Staffing Update

We are delighted to welcome Miss Chay Crawford and Mrs Jennifer Lovie to the team. Miss Crawford will be teaching P6/5. Mrs Lovie will be teaching a variety of curricular areas throughout the week and will get to know many classes. She will also teach P6/5 one day a week.

Mrs Louise Paterson and Mrs Sarah Andrew will be leaving us in a few weeks to start their maternity leave. This will be Mrs Paterson's firstborn and Mrs Andrew's second baby. We wish them the best of luck and look forward to hearing of the new arrivals.

Class Update

P2H will now become P2/1 this is to accommodate any new Primary 1 children over the course of the year. This will not impact the current class configuration.

Two zebra crossings have been installed on Fintray Road. We would like to encourage children to use the crossing at the bottom of the hill. The playground gate is the Pupil Entrance to the School. This crossing will also be supervised by Florence, our crossing patroller.

Please encourage your children to exercise caution if using these crossings independently at anytime and ensure cars have stopped before they step on the crossing.

Morning Drop-Off

Pupils should arrive at school from 0850 and enter the school site via the playground entrance gates. These gates will be closed at 9am. For safety reasons, please do not gather around the gates or on the pavement. Parents are welcome to come into the playground until their children have established a routine. There is no supervision in the playground before 9am. The Primary 6 and 7 Buddies will be on hand to help any of the younger children.

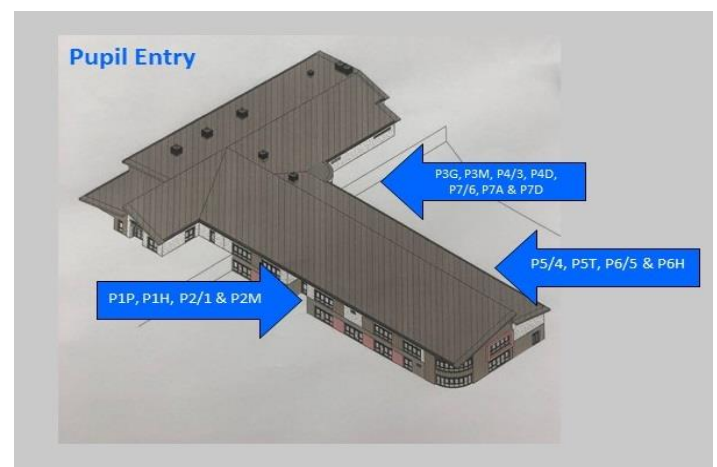

Pupils will be collected by their teachers at 9am. Please see the diagram above which details the

pupil entrance doors and where the children should line up in the morning.

We would encourage children to walk or 'scoot' to school. We have facilities to 'park' scooters at the main entrance and inside the playground gates.

If you have to drive your children to school. Please use the car park at the MUGA and walk over to school. There is also a drop off zone available, however please ensure the taxis can access this to drop off children. The car park at the main school entrance is strictly for Staff, Disabled Access and Visitors only. This should **never** be used to drop children off as this may cause issues and congestion with the new crossings. We thank you for your co-operation in this matter.

Pick up - 1515

Primary 1 and 2 children should be collected by a responsible person (this may include siblings). It is essential that Class Teachers are aware of arrangements and if someone different is going to collect your child, please ensure you inform the Class Teacher by letter or email.

During Primary 3 some parents may feel that it is appropriate for their child to walk home independently. We would encourage this independence but again ask that you keep the Class Teacher informed.

Please see the diagram below for exit doors. Please note the infant pick up point. At the pick up point, teachers will line the children up in classes. When your child reaches the front of the line please come forward to collect them. For safety reasons it is essential that teachers 'hand over' your child to you rather than sending them

to locate you in the playground. Once you have collected your child please leave the pick up area to keep the area as clear as possible.

P4-7 will be dismissed from the doors on the following diagram. The expectation is that they will walk independently. If this is not the case or if there is a change to the arrangements, please let the Class Teacher know.

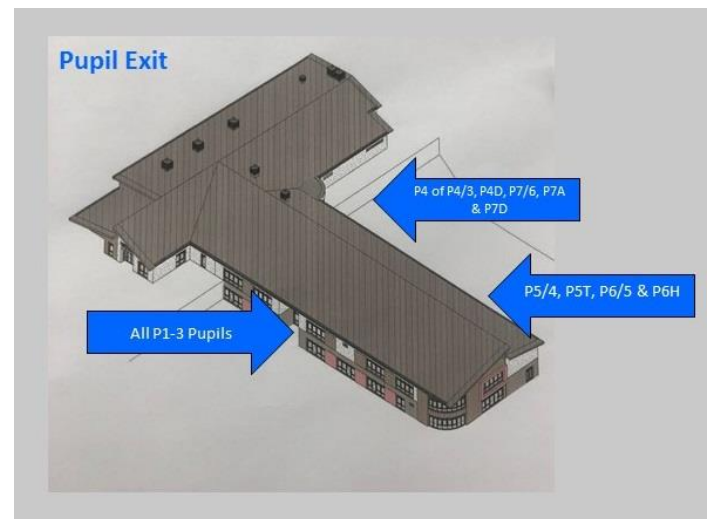

The Club@Kinellar

We are delighted that The Club are launching a Kinellar branch after the success of The Club@Midmill. They will run a breakfast club from 0730-0900 and an afterschool club from 1515-1800. Children should be dropped off and collected at the main school entrance to begin with, this may be subject to change.

If you would like to enquire about spaces, please email or call them directly.

theclubmidmill@gmail.com

07740 547020

Lunches

We are proposing that lunches will remain as they were at Midmill. However this is subject to change.

P4-7 (including P3/4) – 1220-1315

P1-3 1240-1335

If your child is a home lunch they should be met at the front door. If your child is in P4-7 and you are happy for them to walk home independently please let the class teacher know. They should return to school via the Playgorund gates.

iPay Impact

This is the system used to order and pay for lunches. Please see attached information.

P1 Phase-in Period

Our new Primary 1 children will attend for half days during the first two weeks of Term One. Please see timetable below as a reminder. Normal pick up and drop off arrangements apply.

Date	9:00am – 11:30am	12:45pm – 3:15pm
20.08	In-Service	In-Service
21.08	Closure Day	Closure Day
22.08	Group A	Group B
23.08	Group C	Group A
24.08	Group B	Group C
27.08	Group A and C	Group B
28.08	Group A and B	Group C
29.08	Group B and C	Group A
30.08	Group A and C	Group B
31.08	Group A, B and C	Assessment
03.09	Full days begin	

Parent Council

Thank you to the Parent Council for organising a very successful and enjoyable ‘Walk Home’ from Midmill.

We were fortunate to have superb weather. This event raised £3200 which the Parent Council will use to buy new playground equipment for pupils to enjoy. Thank you for your continued support.

Open Evening

We plan to hold our usual ‘Meet the Teacher’ event this year. This will give Parents and the Community a chance to see the new building. This date will be confirmed.

Achievements

We were delighted to celebrate and recognise a vareity of achievements at our end of term assembly with our annual awards. Congratulations!

- Achievement – Stella Walker
- Happiness – Jedida Adeoye
- Respect – Finlay Donald-Bruce
- Honesty – Tristan Davidson

- Early Level Literacy – Isla Richart
- Numeracy Improvement – Sophie Hulcup
- Health and Wellbeing Award – Kyle Masson
- Science & Engineering – Aimee Paterson
- Scots Language Quaich – Maisy Shaw
- Environmental Shield – P7A & P7/6
- Class Excellence Award – P4C

- Anderson Cup for Manners in Dining Hall - Victoria Armas
- Middler Cup for Staff Co-operation – Isla Dewar
- Louise Mathers Cup for Caring for Others – Cassie Barber

Mackie Memorial Cup for Effort and Achievement – Edward Quin
Stuart Murray Shield for Endeavour – Alice Cooper
Anne Gray Cup for Fair Play / Helping in the Playground – Scott Robertson

Sports Day Winning House – Clinterty
House Cup – Begglesley

Head Girl and Boy

We were delighted to appoint our very first Head Girl (Lexie MacDonald) and Boy (Ben Smith) at the end of last term. They will work alongside SMT and the House Captain Team.



House Captains and Vice Captains

We would like to introduce our new House/Vice Captains.

Begglesley – Katya Todd and Daniel Burns

Clinterty – Fraser Patience and Mackenzie

Fernie-Fortune

Glasgowforest – Evie Glezer and Leah Simpson

Tappie – Lyall Clarkson and Morgan Shaw

Caskieben – Theo Allan and Matthew Simpson



School Uniform

Children are expected to wear school uniform- this includes black shoes. We hope that creating a strong identity for the children will help them to take pride in their school community.

Now that we are a 400+ school, we are experiencing a huge volume of lost property. All uniform items, jackets and lunch boxes should be named. Un-named items will be held for a short period of time before being disposed of.



PE Kits

Pupils should ensure they bring the correct PE kits to school each week. Pupils will require an indoor kit containing a t-shirt, shorts, socks and indoor shoes. They will also require an outdoor kit for the MUGA/field. This should contain a t-shirt, jumper, trousers, socks and outdoor shoes. Trousers are advised as the MUGA has a hard surface. Class Teachers will inform you of when children will need an outdoor kit. We encourage pupils to wear their House T-shirts for PE.



Kit List

It would be helpful if your child has the following items for school:

- Stationery – pencils, sharpener, rubber, ruler, glue stick (not Primary 1)
- PE kit – see above
- Water Bottle
- Waterproof Jacket

Teachers may request other items such as folders at a later date.

Art Installation

Artist Mary Bourne worked with pupils to create a variety of Art work for the new building. This has now been installed. We are grateful to all involved and to Mary for ensuring the new school has some Art to cherish for many years to come.

Look out for explanations of each piece in future newsletters!



Dates

Mon 20 Aug	Inservice Day
Tues 21 Aug	Closure Day
Wed 22 Aug	First day of term
Wed 29 Aug	P1 Parent Lunch (B)
Thurs 30 Aug	P1 Parent Lunch (A&C)
Mon 3 Sept	P1 in full time

A full calendar will be available on the school website in the near future. Please check this regularly as this will be updated throughout the year.

School Office

Please find our contact details below.

Kinellar School
Fintray Road
Blackburn
Aberdeenshire
AB21 0SR

01224 472888

kinellar.sch@aberdeenshire.gov.uk

Understandably the School Office will be very busy for the first few weeks. If possible, please communicate directly with Class Teachers. Email addresses will be issued shortly.

Please ensure your child arrives at school with all of their belongings. It can prove difficult to deliver items dropped off at the office in a timely manner. Please ensure children arrive at school on time. If your child is late this will impact on teaching and learning and will be recorded. This is also time consuming for the Admin Team.

Contact us

As always if there is anything we can help you with, please do not hesitate to contact us

Mrs Pamela Farquhar - HT

pamela.farquhar@aberdeenshire.gov.uk

Acting DHT (Nursery – P3) - Miss Cara Morrison

cara.morrison@aberdeenshire.gov.uk

DHT (P4/3-P7) - Miss Katie Finch

katie.finch@aberdeenshire.gov.uk